

JACKSON COUNTY, OHIO  
 GEODETIC CONTROL SURVEY

W.O. 96017

MAP PROJECTION: LAMBERT

ORDER OF SURVEY: FIRST

NAD 83/86 \* OHIO STATE PLANE COORDINATE SYSTEM \* SOUTH ZONE

COUNTY		NAME OF STATION		YEAR
JACKSON COUNTY		5 BEECH HOLLOW		1996
N: 410102.200	E: 1979015.822	LAT.: 39°07'33.53398"	LONG.: 82°27'46.55367"	
GRID FACTOR: 0.99994602	SEA LEVEL FACTOR: 0.99996673	⊕ ANGLE: +0°01'24.67"		
ESTABLISHED BY: GeoMetrics GPS, INC.	YEAR 1996	DISTANCES AND DIRECTIONS TO REFERENCE MARKS AND PROMINENT OBJECTS OBSERVED AT STATION		
		OBJECT	DISTANCE-FT.	MAG. AZIMUTH
VERTICAL DATUM NAVD 88		(SEE SKETCH BELOW)		
ELEVATION (FT.) 695.46				
VERTICAL ORDER: THIRD				

DESCRIPTION OF STATION:

The station is a standard Jackson County, Ohio aluminum survey disk stamped BEECH HOLLOW 5 1996 set flush with the ground in the top of a reinforced poured-in-place concrete monument located in Jackson County, Ohio about 4.0 miles northeast of the town of Wellston. To reach the station from the intersection of U.S. Highway 35 and Route 32 in Jackson proceed northeast along Route 32 a distance of 10.6 miles to the station on the left.

SKETCH OF STATION:  
 APPROX. SCALE: 1" = 30'

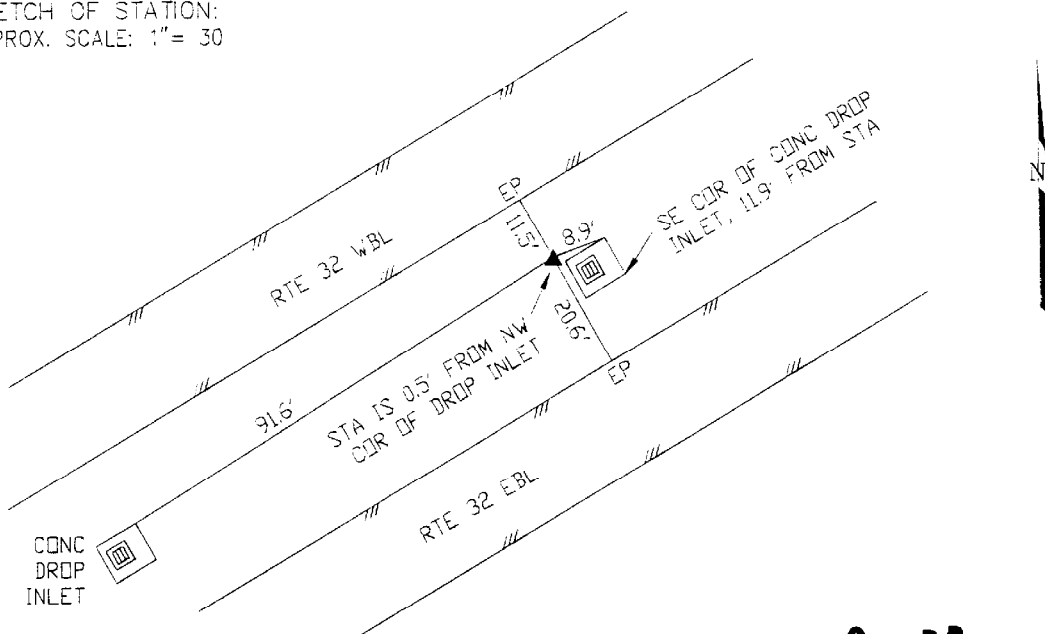

THIS SURVEY DATA PREPARED  
 USING 1 meter = 3.280833 feet

PREPARED BY: EJP	7/96
CHECKED BY: DAR	7/96

**GEOMETRICS**  
 GPS, INC.

355 BUTLER ROAD  
 FREDERICKSBURG, VIRGINIA  
 (540) 372-3499