

JACKSON COUNTY, OHIO
 GEODETIC CONTROL SURVEY

W.O. 96017

MAP PROJECTION: LAMBERT

ORDER OF SURVEY: FIRST

NAD 83/86 * OHIO STATE PLANE COORDINATE SYSTEM * SOUTH ZONE

COUNTY		NAME OF STATION		YEAR
JACKSON COUNTY		25 SYMMES		1996
N: 311564.651	E: 1973350.904	LAT.: 38°51'19.56083"	LONG.: 82°28'58.67766"	
GRID FACTOR: 0.99997824	SEA LEVEL FACTOR: 0.99996907	⊕ ANGLE: +0°00'38.91"		
ESTABLISHED BY: GeoMetrics GPS, INC.	YEAR 1996	DISTANCES AND DIRECTIONS TO REFERENCE MARKS AND PROMINENT OBJECTS OBSERVED AT STATION		
		OBJECT	DISTANCE-FT.	MAG. AZIMUTH
VERTICAL DATUM NAVD 88		(SEE SKETCH BELOW)		
ELEVATION (FT.) 646.57				
VERTICAL ORDER: THIRD				

DESCRIPTION OF STATION:

The station is a standard Jackson County, Ohio aluminum survey disk stamped SYMMES 25 1996 set flush with the ground in the top of a reinforced poured-in-place concrete monument located in Jackson County, Ohio about 5.5 miles southeast of the town of Oak Hill. To reach the station from the intersection of Route 93N and Route 93E in Oak Hill proceed east along Route 279 for a distance of 4.7 miles to its intersection with Route 49, Jimes Emory Road. Turn right and proceed south along Jimes Emory Road for a distance of 1.7 miles to its intersection with Symmes Creek and the station on the right.

SKETCH OF STATION:
 APPROX. SCALE: 1" = 20'

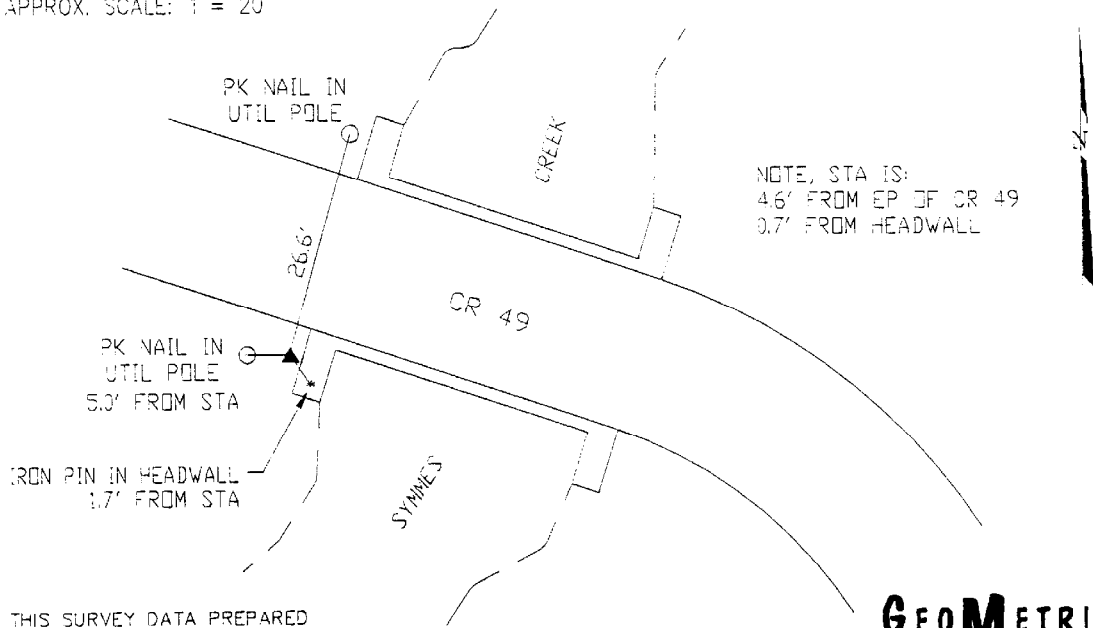

THIS SURVEY DATA PREPARED
 USING 1 meter = 3.280833 feet

PREPARED BY: EJP	7/96
CHECKED BY: DAR	7/96

GEOMETRICS
 GPS, INC.

355 BUTLER ROAD
 FREDERICKSBURG, VIRGINIA
 (540) 372-3499