

JACKSON COUNTY, OHIO
 GEODETIC CONTROL SURVEY

W.O. 96017

MAP PROJECTION: LAMBERT

ORDER OF SURVEY: FIRST

NAD 83/86 * OHIO STATE PLANE COORDINATE SYSTEM * SOUTH ZONE

COUNTY	NAME OF STATION		YEAR
ROSS COUNTY	23 WALLACE		1996
N: 310256.606	E: 1933713.028	LAT.: 38°51'06.40340"	LONG.: 82°37'19.73426"
GRID FACTOR: 0.99997882	SEA LEVEL FACTOR: 0.99995835	⊕ ANGLE: -0°04'39.02"	
ESTABLISHED BY: GeoMetrics GPS, INC.	YEAR 1996	DISTANCES AND DIRECTIONS TO REFERENCE MARKS AND PROMINENT OBJECTS OBSERVED AT STATION	
OBJECT		DISTANCE-FT.	MAG. AZIMUTH
VERTICAL DATUM NAVD 88		(SEE SKETCH BELOW)	
ELEVATION (FT.) 870.80			
VERTICAL ORDER: THIRD			

DESCRIPTION OF STATION:

The station is a standard Jackson County, Ohio aluminum survey disk stamped WALLACE 23 1996 set flush with the ground in the top of a reinforced poured-in-place concrete monument located in Jackson County, Ohio about 4.0 miles southwest of the town of Oak Hill. To reach the station from the intersection of Route 32 and Route 93 in Jackson proceed south along Route 93 for a distance of 14.3 miles to its intersection with Route 140. Turn right and proceed west along Route 140 for a distance of 1.0 miles to its intersection with Route T-338, Monroe Hickory Road. Turn left and proceed south along Monroe Hickory Road for a distance of 0.8 miles to the station on the left.

SKETCH OF STATION:
 APPROX. SCALE: 1" = 20'

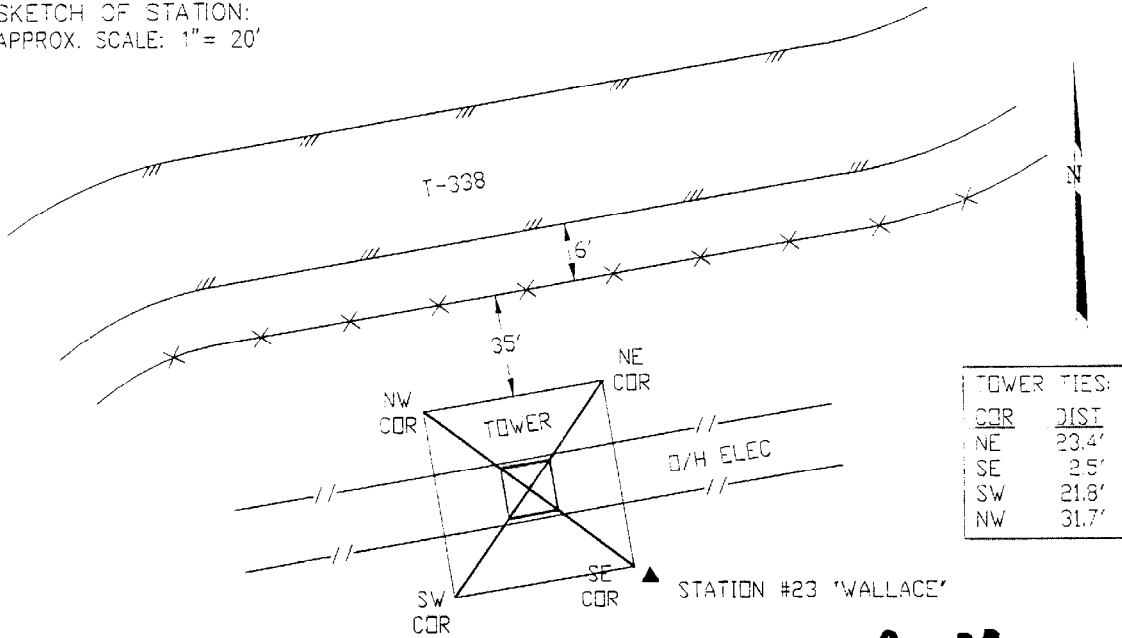

THIS SURVEY DATA PREPARED
 USING 1 meter = 3.280833 feet

PREPARED BY: EJP	7/96
CHECKED BY: DAR	7/96

GEOMETRICS
 GPS, INC.

355 BUTLER ROAD
 FREDERICKSBURG, VIRGINIA
 (540) 372-3499